

**Wire Rope & Accessories Cont.**

Proper use of CM Big Orange Piggyback Wedge Socket Clips

1. Dead end wire rope tail length should be at least 6 rope diameters, but not less than 6 inches beyond the wedge socket. Figure 1.
2. Apply U-bolt and first saddle on dead end rope and the second saddle on live end rope. Install nut. Figures 1 & 2.
3. Position the dual saddle clip so that 3 to 4 inches of dead end rope remain beyond the clip. Figures 1 & 2.
4. Tighten nut evenly. Alternate tightening each nut until reaching that required torque specified. Figure 2.
5. Check that the clip does not pinch or clamp the live wire rope. Apply an initial test load equal to the loads expected in regular use. Be certain rope is secured properly in the wedge socket prior to any use.
6. Inspect for proper rope alignment with wedge socket and retighten the nuts to the specified torque.

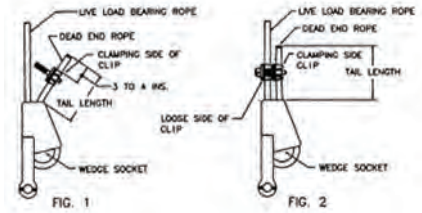

**CM® Big Orange Mid-Grip clips (double saddle)**

- Big Orange Mid-Grip wire rope clips meet Federal Specifications FF-C-450, Type III, Class 1, and will provide maximum holding strength when installed and used according to specifications
- Double grip, double saddle wire rope clips allow full arc wrench swing for quicker installation, retightening or disassembly of nuts
- Unlike U-bolt type rope clips, Mid-Grip clips cannot be installed incorrectly with the saddle not on the live rope end
- Forged from special bar quality steel with the sizes clearly marked on the saddles
- Hot galvanized with galvanized heavy hex nuts. When properly used, Big Orange Mid-Grip clips will give terminal efficiency rating of approximately 80% of the catalog nominal strengths of new wire rope

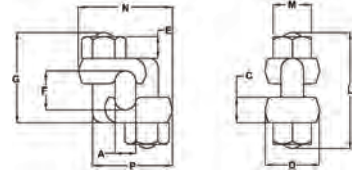

Part No.	Mfg. No.	Rope Size	A	B	C	D	Thread	F	G	L	M	N	Minimum Number of Clips	Rope Turnback	Torque	Weight
0507526	M2246	3/16", 1/4"	.28	1.25	.34	1.94	3/8-16	1.50	1.28	1.56	1.69	1.28	2	4"	30 ft/lb	21 lb/100 pcs
0507527	M2247D	5/16"	.34	1.38	.44	1.06	3/8-16	1.63	1.47	1.81	1.69	1.41	2	5"	30 ft/lb	27 lb/100 pcs
0507528	M2248	3/8"	.41	1.56	.50	1.06	7/16-14	1.75	1.81	2.31	1.75	1.85	2	5-1/4"	45 ft/lb	45 lb/100 pcs
0507529	M2250	1/2"	.50	1.78	.56	1.25	1/2-13	1.00	2.19	2.75	1.88	2.06	3	11"	65 ft/lb	65 lb/100 pcs
0507530	M2251	9/16", 5/8"	.66	2.25	.69	1.50	5/8-11	1.25	2.69	3.31	1.06	1.59	3	13-1/2"	130 ft/lb	113 lb/100 pcs
0507531	M2252	3/4"	.81	2.69	.88	1.81	3/4-10	1.50	2.94	3.44	1.25	3.06	3	16"	225 ft/lb	170 lb/100 pcs

LIFTING & RIGGING

**Closed Thimbles**



- Made for wire rope turn back to form a cable loop
- Manufactured in accordance to Fed. Spec. FF-T-276-B
- Zinc Plated

Part No.	Rope Size	Weight
43441	1/8"	0.024 lb
43442	3/16"	0.025 lb
43443	1/4"	0.04 lb
43444	5/16"	0.05 lb
43445	3/8"	0.09 lb
43446	7/16"	0.13 lb
43447	1/2"	0.16 lb
43449	5/8"	0.31 lb
43450	3/4"	0.40 lb
43451	7/8"	0.56 lb
43452	1"	0.88 lb
43453	1-1/8"	1.01 lb
43454	1-1/4"	1.43 lb
43456	1-1/2"	2.40 lb

**Thimble**

304 stainless steel - standard



Part No.	Rope Size
74605	1/16" - 5/64"
74606	3/32" - 1/8"
74607	3/16"
74608	1/4"
74609	5/16"
74610	3/8"

**Swage Sleeves**

Aluminum - Hour Glass

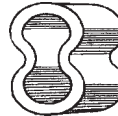

Part No.	Diameter	Length
43378	1/32"	3/8"
43379	3/64"	3/8"
43380	1/16"	3/8"
43381	3/32"	1/2"
43383	1/8"	5/8"
43385	5/32"	11/16"
43386	3/16"	1"
43388	7/32"	1-1/16"
43389	1/4"	1-1/8"
43390	5/16"	1-1/4"
43391	3/8"	1-7/16"
43392	7/16"	1-11/16"

**Swage Sleeves Thin Wall**

Aluminum - Hour Glass



Part No.	Diameter	Length
43387	3/16"	1"
43382	1/8"	5/8"
43384	5/32"	11/16"

**Button (Stop) Sleeves**

Aluminum

For adding a stop to wire rope to prevent pulling through a guide.



They can support approximately 1/3 of WLL of the corresponding wire rope when properly swaged to rope.

Part No.	Diameter	Length
43394	1/16"	5/32"
43395	3/32"	9/32"
43396	1/8"	5/16"
43397	5/32"	11/32"
43398	3/16"	11/32"
43399	1/4"	3/4"
43400	5/16"	3/4"

**Swaging Tools**

One tool covers two tasks, such as cutting wire ropes and swaging arm oval sleeves.



Part No.	Cable Diameter	Weight
0578180	1/16" - 1/8"	2.55 lb
0578181	1/16" - 3/16"	6.35 lb

**Cable Cutters**

These cutters are actuated by striking with a hammer, they are easy to operate and do a superior cutting job with only a few blows of a hammer. These cutters are precision engineered to deliver a cut without affecting the original roundness of the wire rope. The blades and dies are made of the finest tool steel available, heat treated and ground to close tolerances.

Part No.	Mfg. No.	Cable Diameter
45701	1	3/4"
45702	1A	1-1/16"
45703	2	1-1/2"